

BENEFITS

Facilitating user choice in image display, BERCHTOLD's ChromoView™ flat panel arms support all major 3rd-party monitor and cable solutions. By adapting to this broad range of imaging options, BERCHTOLD's monitor arms keep all your options on the table. Monitor selection can be based on best-in-class image quality, not physical compatibility or other support issues. Whatever your choice, ChromoView will support it, with superior maneuverability and effortless positioning that helps you get the most out of your system.

FEATURES

- Supports most flat panel displays up to and including 26"
- Certified for all major 3rd-party cable bundles, including the latest in HD fiber-optic technology
- Easy to move, courtesy of smooth and flexible suspension, combining low effort with a wide range of motion
- Counterbalanced bracket design reduces potential for monitor drift
- Wide range of mounting options; from stand-alone to combinations with lights, camera arms, or equipment booms
- 60 degree upward tilt moves displays up and out of the way when not in use
- Compatible with both standard BERCHTOLD sterilizable handles, and a wide range of disposable handle covers
- 26" bracket available as an upgrade to many existing BERCHTOLD flat panel monitor suspensions

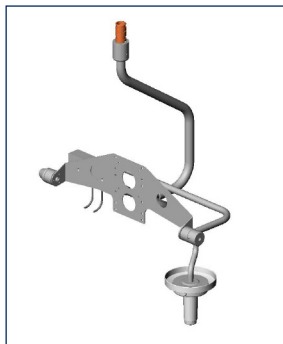

TECHNICAL DATA

- Monitor weight range: up to 25.4 lb (11.5 kg)
- Bracket width: 31.5" (80 cm)
- Vertical travel: 48" (121 cm)
- 330° rotation at each joint
- Compatible with both 24v DC and 110v AC power
- UL listed